

Timberline Acres West No. 3

Developed by:
K V W Venture

LOCATION MAP
NO SCALE

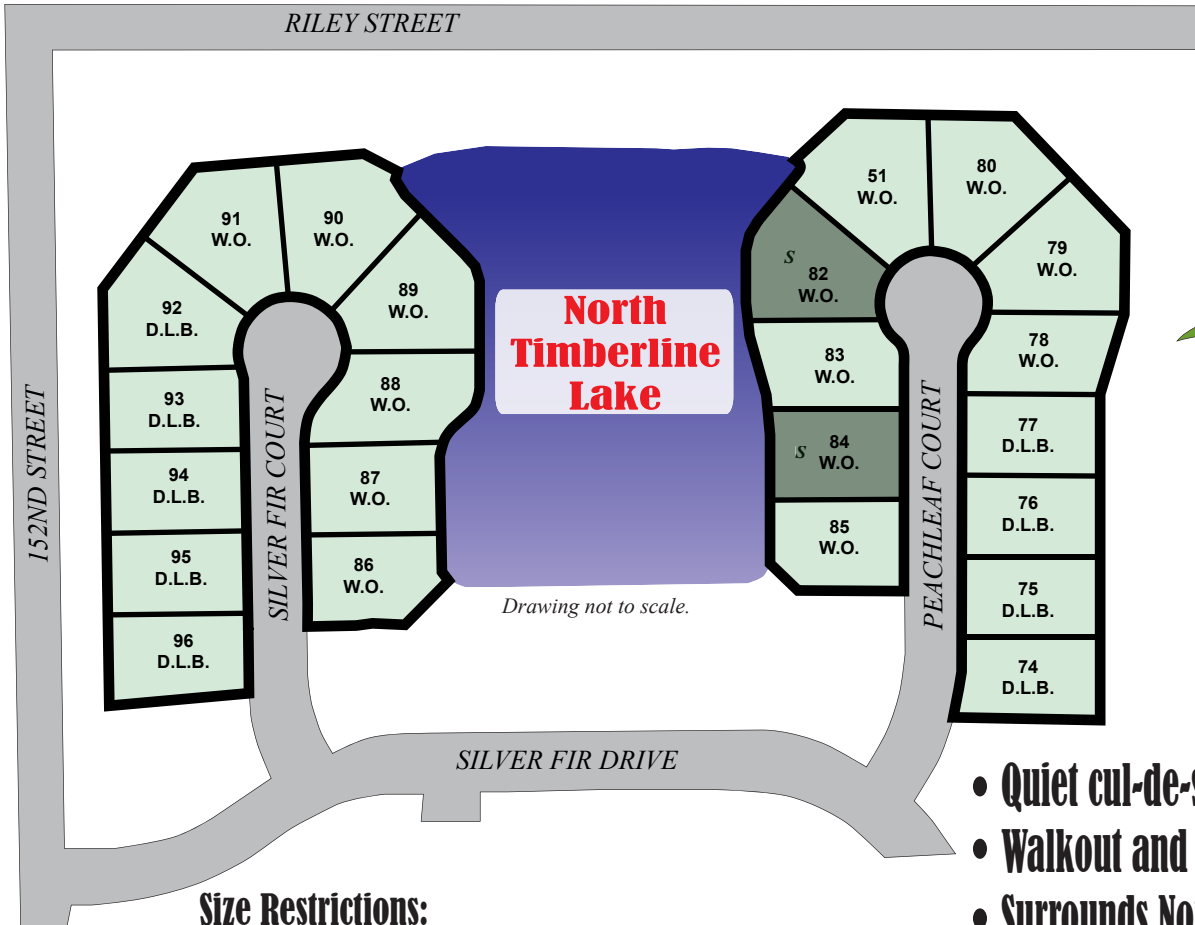
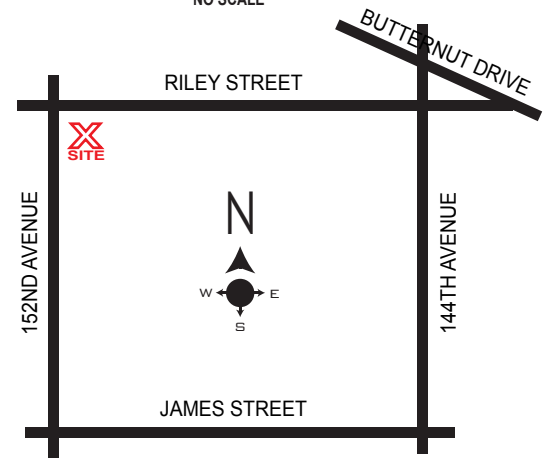

S = SOLD

Size Restrictions:

- 1600 sq. ft. 1-story
- 2000 sq. ft. 1-1/2 story (main & 2nd)
- 2000 sq. ft. 2-story
- 1600 sq. ft. bi-level (main)
- 2000 sq. ft. tri-level (2 floors)

Lot Prices from \$71,900

- Quiet cul-de-sac lots
- Walkout and daylight lots available
- Surrounds North Timberline Lake
- Wooded area, sandy bottom lake
- Near the Lake Michigan shoreline
- Bike and activity trails nearby
- Holland school district
- Park Township, Ottawa County

Visit www.KoetjeCommunities.com for lot and building info.
Sales & info. call John Sr. or assistant Sally @ (616) 538-4241

*Information deemed reliable,
but not guaranteed.*